

Back-To-Wall (BTW) Toilet Suite

Installation Instructions

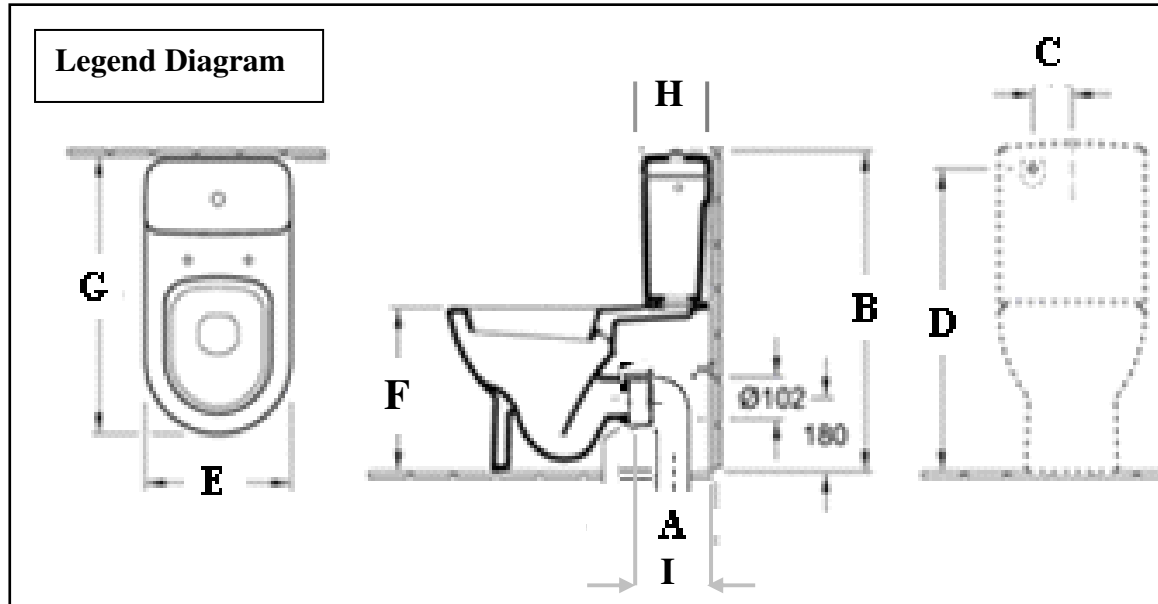

Dimension Table

Toilet Suite	A	B	C	D	E	F	G	H	I	X
* Architectura BTW Toilet	140	765	100	725	370	400	700	175	195	225
Aveo BTW Toilet Suite	140	810	100	740	410	400	730	165	235	265
Bellevue BTW Toilet Suite	140	940	100	845	375	410	710	155	215	245
Century CC Toilet Suite	140	830	100	745	370	395	710	180	190	220
Editionals BTW Toilet Suite	140	815	100	755	380	400	720	145	195	225
Magnum BTW Toilet Suite	140	820	100	740	355	400	695	175	190	220
Omnia Pro BTW Toilet	140	770	100	725	355	390	690	180	190	220
Pavia BTW toilet	140	830	100	780	355	390	690	175	190	220
Subway BTW Toilet Suite	140	780	100	740	370	400	680	185	215	245
Sunny BTW Toilet Suite	140	870	100	785	370	400	700	180	190	220

A. = 'S' trap set out is variable and ranges from 70 to 250 depending on the vario bend and toilet supplied, recommended rough in for 'S' trap is 140mm.

B. = overall height of the toilet

C. = offset from centre line to rear water rough in position

D. = height on centreline to rear water inlet

E. = width of the toilet

F. = height of pan excluding the seat

G. = length of toilet

H. = width of the cistern

I. = distance from back of the pan to the start of the ceramic spigot.

* = these BTW toilets are also available with bottom water inlet option.

X = vario bend cutting distance, See Figure 1 on page 2.

The manufacturer reserves the right to change specifications with out notice.

Standard Vitreous china manufacturing tolerances apply.

Prior to commencing installation

1. The cistern is supplied standard with a 15mm (½") male iron cistern tap. A 15mm (½") female iron BSP wall elbow should be installed flush with the finished wall for best practice (if not, see trouble shooting guide Page 4)
2. If using the 8701 or 8702 large set out vario bend, has pan collar been installed flush with the floor? (if not, see trouble shooting guide Page 4)
3. Check to confirm that all the parts of the toilet are complete and undamaged. No claim for damage or faults will be accepted after installation.
4. Has the inlet valve been removed from the transport position in the side of the cistern and the hole plugged with the white plug supplied in the cistern fixing kit bag? (disregard this step if you are choosing to use the top of the cistern side inlet option, not suggested for aesthetic reasons)
5. Cistern check; is the internal overflow tube facing the left hand side of the cistern, if not, please remove and rotate 180 degrees and reinstall.
6. The height and distance from the centre of the cistern to the rear water entry point for each model is set out in the dimension table and the measurement is from the finished floor height. (Please allow for the height of tiles or flooring when roughing in) The set out height does not allow for any bedding of the pan into a mortar base (please allow for this if the pan is being installed in this fashion). Argent Australia does not recommend bedding the pan.

Installation

- Vario bend set up for S trap installations

1) Check that the floor and wall are level and perpendicular and free of any obstructions that could hinder the installation of the toilet.

2) For S-Trap installation, insert the vario bend into the pan collar after discarding the original fluted seal supplied for the bottom of the vario bend (not suitable for Australian standard DWV pipe.) **The top of the pan collar must be flush with the finished floor for 8701/8702 large set out vario bend, typical above floor pan collar installation is normal for 8711/8712 small set out vario bends.**

3) To work out the length that the vario bend needs to be trimmed to, first confirm that the ceramic spigot on the pan you have is the same distance from the back of the pan to the start of the ceramic spigot as per detail (I) in the dimension table. Add 30mm to this measurement.

Cut the vario bend ensuring the distance X is measured from the finished wall to the front of the bend and 180mm from finished floor to the centre of the pan outlet. Allow extra height for bedding if being used. (**X = Dimension table reference I plus 30mm**)

Example; For Omnia Pro BTW, confirm dimension (I) is 195mm add 30mm = 225mm. Trim Vario bend to 225mm from the finished wall as per X in the dimension table.

4) Install the brace to the wall and fix the vario bend into position by securing to the brace (See fig 3). Please check the measurements. Place the rubber seal over the front of the vario bend (See fig 3). Lubricate the rubber with an approved silicon based lubricant.

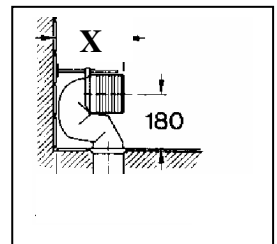

Fig 1

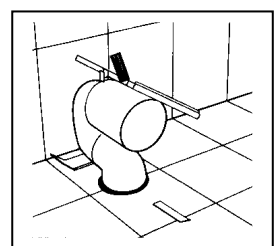

Fig 2

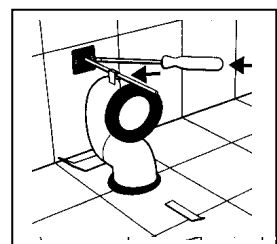

Fig 3

- **P trap set up**

5) To work out the length that the DWV pipe needs to be, first confirm that the ceramic spigot on the pan you have is the same distance from the back of the pan to the start of the ceramic spigot as per detail (I) in the dimension table. Calculate the amount the pan spigot will go into the pan collar you have selected to use, (not supplied with the toilet) and allow a small clearance, appropriate to the pan collar selected, off dimension (I)

- **Pan to floor fixing**

6) Place the toilet pan in the position in which it is to be installed and mark the outline of the pan on the floor under the fastening holes. Mark the centre point on the drawn line under the position of the centre of the fastening holes. (See Fig 4).

7) Remove the toilet pan and join the two marked points with a line. Mark two drilling holes on this line at a distance of 45mm from the outer edge of the toilet pan. Drill the two marked fastening holes and attach the supplied plastic brackets as shown in the drawing (see Fig 5). Ensure that the outer contour of the ceramic unit is parallel with the outer surface of the mounting bracket. Place the toilet pan back over the fastening brackets to check that it is in the correct position for installation (see Fig 6).

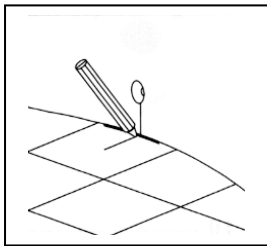

Fig 4

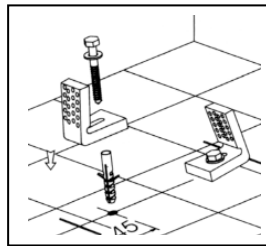

Fig 5

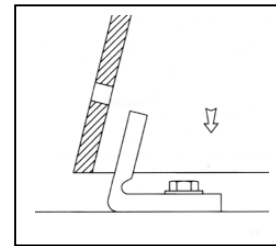

Fig 6

- **Connecting cistern to Pan**

8) Remove the pan and check that the cistern is set up correctly as per the cistern set up instructions on page 2

9) Connect the cistern to the pan. Move the whole unit into position, additional help may be advantageous for this stage. Insert the plastic sleeves in the holes on the side of the pan and screw the pan to the brackets with the screws provided. Place white cover caps into the heads of the screws.

- **Water Connection**

10) Connect the water to the inlet valve using the 3/8 copper tube supplied, this may need to be bent depending on the amount your cistern tap project into the cistern. (See fig 7) Fit the cistern lid and cistern button.

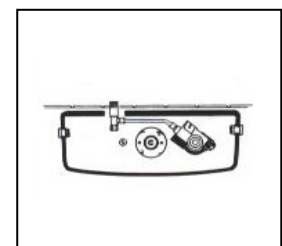

Fig 7

11) Please test flush the toilet multiple times to check that it is flushing correctly and that there are no leaks. Once you are confident that the toilet flushes correctly and there are no leaks, run a bead of silicon around the base of the pan.

11) Fit the seat as per the seat instructions.



Villeroy & Boch

1748

Trouble shooting guide

1. Please **do not use Blue Loo** or similar products inside the cistern as the chemicals released will deteriorate the fittings inside the cistern. Products of this nature should be attached to the pan if being used. (Ceramicplus easy clean dirt repellent finish is available on most Villeroy & Boch Pans.)
2. **Bottom water inlet** is available on some V&B toilets, see dimension table on page 1
3. **Top of cistern side water inlet** is available to both sides for most Villeroy & Boch toilets; this is not suggested as it can diminish the aesthetic result of the installation. It is however, suitable where you choose not to have the hidden rear water inlet. (i.e. retro installations)
4. **Retro fit top fixing cistern kit**, Part # 994054, should you need to remove the cistern for maintenance, a retro fit top fixing kit is available to ensure you do not have to remove the pan to get the cistern off.
5. **½ inch male iron rear water adaptor**, Part # 010720806, this adaptor will allow you to install the cistern in the event that it has been roughed in with a male iron ½ thread instead of the recommended Female iron wall elbow.
6. **vario bend adaptor for DWV pipe**, Part # 8722, this adaptor will allow the 8701/8702 vario bend to be installed into DWV pipe without having to install the pan collar flush with the floor, it is used in lieu of the pan collar.

Please note: Australian Standards AS/NZ6400:2005 applies.

IE Suitable for high pressure applications up to 500KPA.

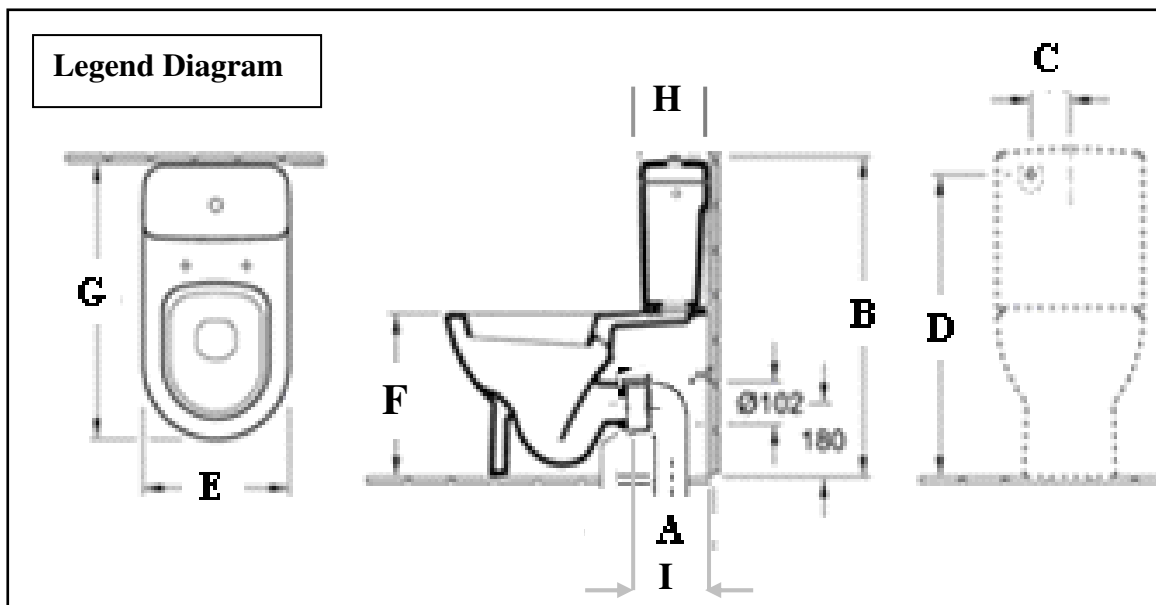

V2CD091009