



**HUB**



## Hub Bathroom Accessories

Cylindrical forms reduced to essentials. Hub is a unique range of accessories designed to suit a distinctively modern bathroom. Undemanding in presence, the slim-line rails combine with the circular wall plate in perfect harmony.

The comprehensive range enables a wide range of applications, allowing you to make the right choice for your bathroom design. Hub is available in a mirror like chrome finish.

## Hub Features:

- Comprehensive range of products to suit most requirements
- Solid brass construction
- Unique fixing system for quick and easy installation
- 5 year warranty

Hub has been created with the latest design trends in bathroom products in mind. Please ask for a brochure on complimentary tapware products.



Hub Hand Towel Bar 300mm Code: 267513 Chrome  
Hub Single Towel Rail 600mm Code: 267524 Chrome  
Hub Single Towel Rail 800mm Code: 267532 Chrome

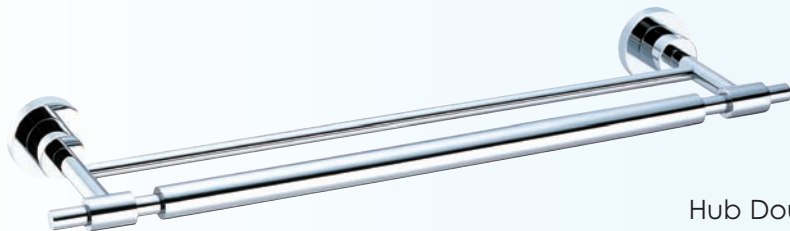

Hub Double Towel Rail 600mm Code: 267548  
Chrome

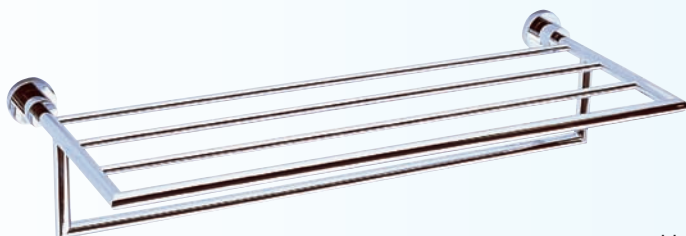

Hub Bath Towel Rack 600mm Code: 267544 Chrome

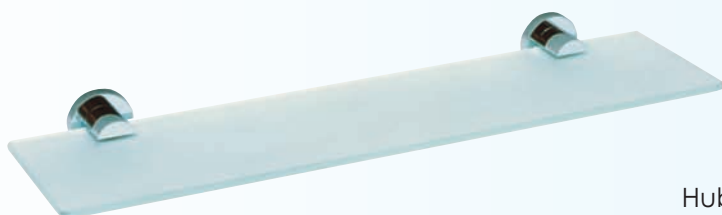

Hub Glass Shelf 450mm Code: 269198  
Hub Glass Shelf 600mm Code: 269199



Hub Tumbler & Holder  
Code: 267558 Chrome



Hub Covered Toilet Roll Holder  
Code: 267551 Chrome

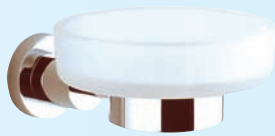

Hub Soap Dish  
Code: 267559 Chrome

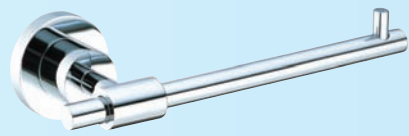

Hub Toilet Roll Holder  
Code: 267552 Chrome



Hub Liquid Soap Dispenser  
Code: 267589 Chrome



Hub Toilet Brush Set  
Code: 267594 Chrome



Hub Towel Ring  
Code: 267560 Chrome



Hub Robe Hook  
Code: 267553

# technical details

**Liquid Soap Dispenser**

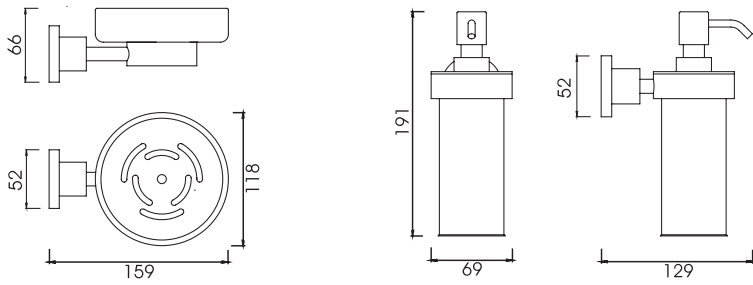

**Toilet Brush Set**

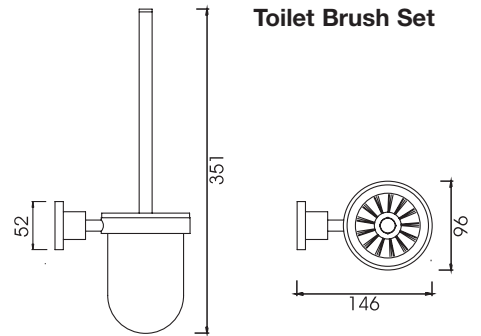

**Tumbler & Holder**

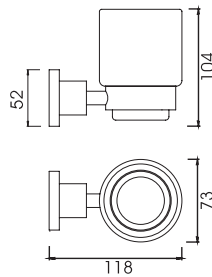

**Toilet Roll Holder**

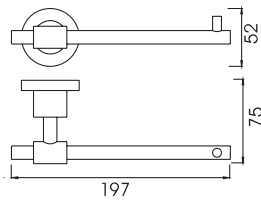

**Covered Toilet Roll Holder**

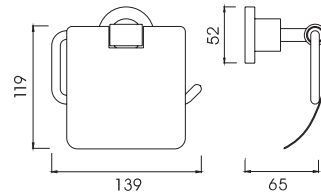

**Towel Ring**

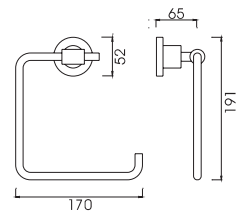

**Single Towel Rail**

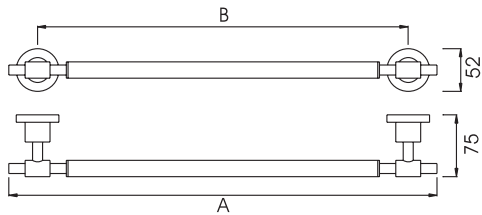

**Bath Towel Rack**

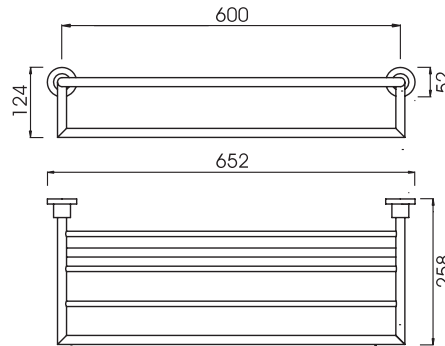

**Robe Hook**

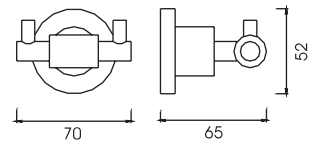

| Code   | A   | B   |
|--------|-----|-----|
| 267513 | 370 | 300 |
| 267524 | 670 | 600 |
| 267532 | 870 | 800 |

**Double Towel Rail**

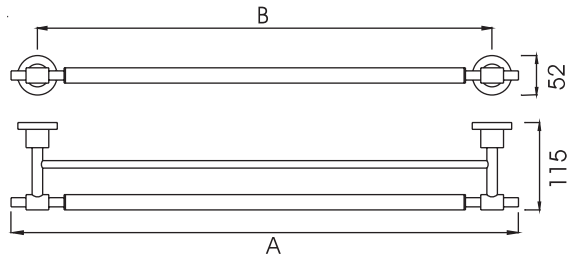

**Glass Shelf**

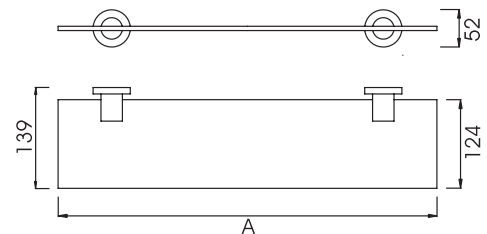

| Code   | A   | B   |
|--------|-----|-----|
| 267548 | 670 | 600 |
| 267564 | 870 | 800 |

| Code   | A   |
|--------|-----|
| 269198 | 450 |
| 269199 | 600 |



**Brisbane**

18 Wandoo Street  
Fortitude Valley QLD 4006  
Phone: 07 3252 6101  
Fax: 1300 656 057

**Sydney**

80 Abercrombie Street  
Chippendale NSW 2008  
Phone: 02 8394 5800  
Fax: 02 8394 5888

**Melbourne**

206-208 Coventry Street  
South Melbourne VIC 3205  
Phone: 03 9682 1231  
Fax: 03 9696 7661

**Perth**

Unit 1/40 Collingwood Street  
Osborne Park WA 6017  
Phone: 08 9445 0500  
Fax: 08 9445 0510

**Argent Central**

PO Box 2093  
Fortitude Valley QLD 4006  
Phone: 1300 364 748  
Fax: 1300 656 057

Technical Advice Hotline: 1800 356 717

E-mail: [ac@argentaust.com.au](mailto:ac@argentaust.com.au)

Website: [www.argentaust.com.au](http://www.argentaust.com.au)