



# O.novo 2.0 600 Wall Basin

1 Taphole, No Overflow

## Product Image



## Product Details

<b>SKU:</b>	<b>4A416201CB</b>
Brand:	Villeroy & Boch
Range:	O.novo 2.0
Warranty:	10 Years
Product Width:	600 mm
Product Depth:	460 mm
WELS:	N/A

## Additional Features

### Required Product

WM approved 32mm BSP waste

### Recommended Products

K328F for Hospital Hygiene compliance, K316-D series for general use

### Additional Notes

\* Hospital Hygiene & AS1428 Dimensional Compliant

## Technical Specification

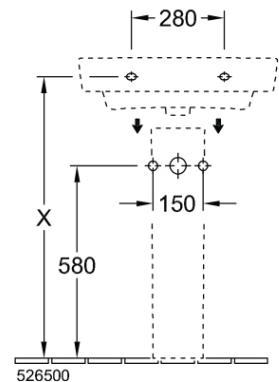
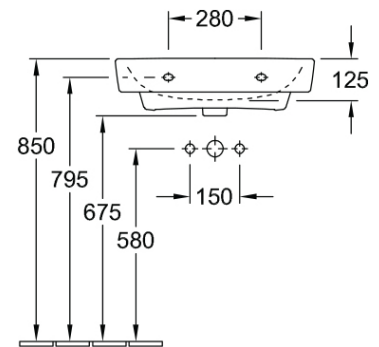
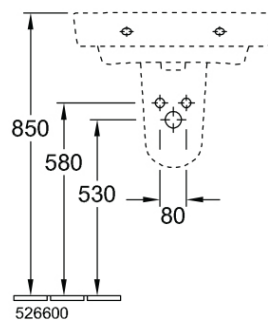
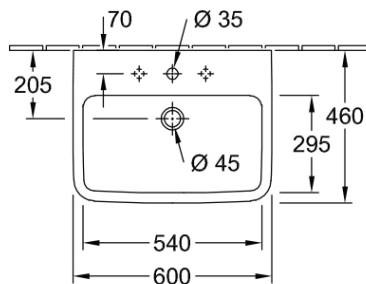

Note: All dimensions are in millimetres and are subject to normal manufacturing variations. Always use the physical product measurements for cut-outs and rough-ins as the technical details shown may differ from the actual product. Use acetic cured silicone sealant. Do not use epoxy type adhesives. Clean with damp cloth. Do not use abrasive cleaners, liquids or pastes.