

## INSTALLATION TIPS

### CARE + MAINTENANCE

Care must be taken to dry any spillage or leakage of water which may gain access to furniture. It is recommended that vanities are installed to avoid splashes from wet areas such as baths, spas and showers.

All wood composite veneers and polyurethane lacquer are water resistant only. To ensure the quality of finish is maintained, wipe up all spills with a clean lightly moistened cloth as soon as they occur. Use only a soft cloth, or a weak solution of non-abrasive detergent. Do not expose to excessive heat e.g. from hot hair styling equipment or naked flames.

To restore accidental scratches, burns etc. on two pack polyurethane parts or acrylic tops, rub gently with car cutting compound, car polish or household brass/silver cleaner.

To restore accidental scratches, burns etc. on veneer parts, paint with similar coloured wood restoration pens, let settle for one minute and wipe off excess with soft cloth.

### WARRANTY INFORMATION

The Argent furniture warranty applies to Argent furniture only. The Argent Warranty is 5 years against manufacturing fault.

#### Finishes

All finishes are warranted against chipping and flaking, excluding normal wear and tear for five (5) years from date of purchase. Fading of colour due to excessive exposure to sunlight is excluded from the warranty.

#### Exclusions

This warranty is for normal domestic limited use only and excludes any defect or injury caused by or resulting from misuse, abuse or neglect, accidental damage, improper installation or other alterations or modifications which affect the reliability or performance of the unit that are not attributable to faulty manufacture.

For full Warranty information visit [www.argentaust.com.au](http://www.argentaust.com.au)



**Brisbane**  
Level 3 / 18 Wandoo Street  
Fortitude Valley QLD 4006

**Sydney**  
80 Abercrombie Street  
Chippendale NSW 2008

**Melbourne**  
206-208 Coventry Street  
South Melbourne VIC 3205

**Perth**  
Unit 1 / 40 Collingwood Street  
Osborne Park WA 6017

**Technical Advice**  
1300 356 717

**Fax**  
1300 656 057

[www.argentaust.com.au](http://www.argentaust.com.au)

### STORE THIS DOCUMENT

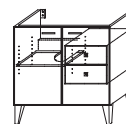

**C10SF0801**  
**C10SF0805**  
**C10SF0806**  
Centra 800 Floor Mounted

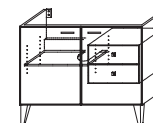

**C10SF1001**  
**C10SF1005**  
**C10SF1006**  
Centra 1000 Floor Mounted

## Centra Floor Mounted

### INSTALLATION INSTRUCTIONS

**INSPECT THE FURNITURE TO ENSURE NO DAMAGE HAS OCCURRED DURING TRANSIT. IF DAMAGE HAS OCCURRED, OR VISIBLE DEFECTS EXIST, DO NOT PROCEED WITH INSTALLATION AND ADVISE ARGENT IMMEDIATELY.**

#### **Ⓐ PRIOR TO INSTALLATION**

Argent recommends a qualified trade person fit your vanity. Ensure your furniture is installed to relevant building codes and Australian standards.

Please note, Argent will not be liable for the cost of installation or removal of the furniture and the warranty will be voided if damage occurred during or after installation.

To establish the correct height for the basin assemble as per steps **1-4** shown in drawings and mark fixing holes.

Fit wall hung basin at required height to secure stud or frame landing, ensure level. Fit plumbing.

Remove **(1)** any shelves, doors and draws of vanity and set aside carefully. Carefully turn vanity on to it's back. Attach **(2)** vanity feet provided. Secure all four feet with screws provided. Line feet up with edge of body box or just inside **(3)** as shown.

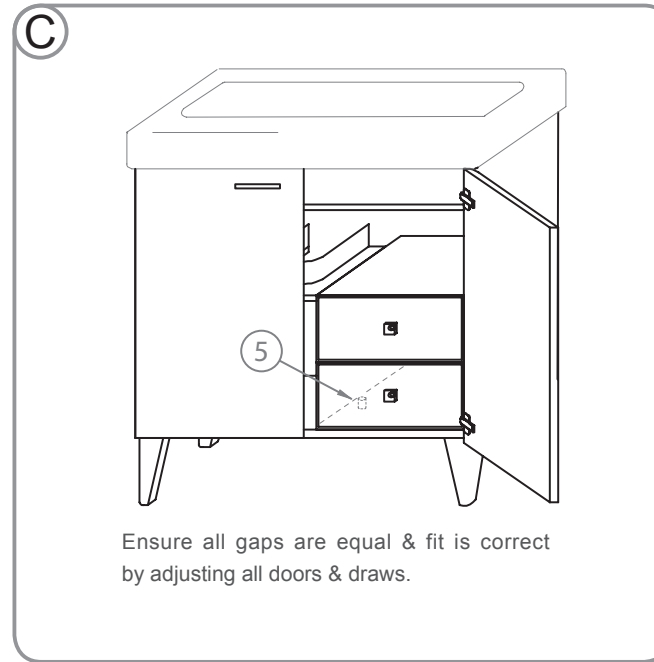
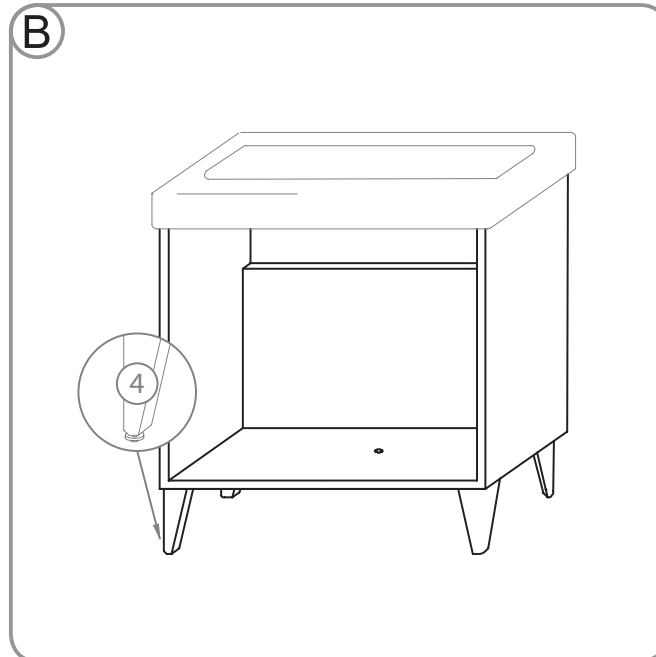
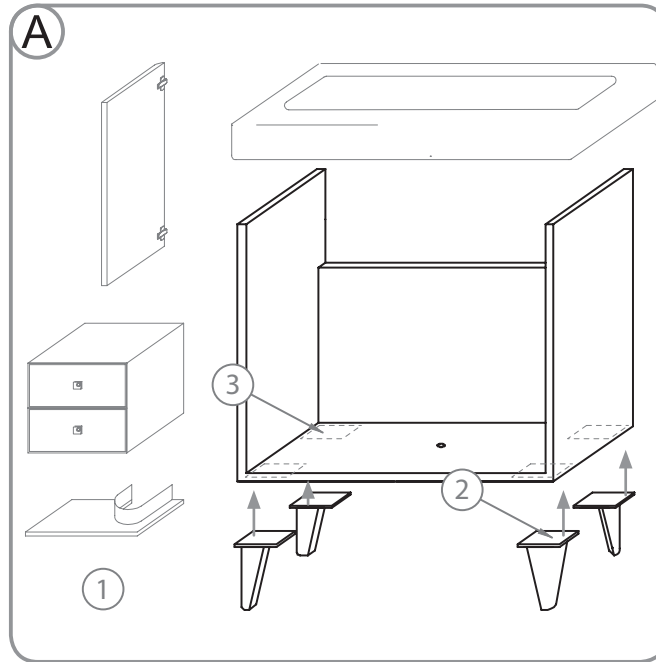

#### **Ⓑ MEASURE & MARK**

Hold vanity at an angle as you carefully push the vanity in towards and up and against the wall. If ground is uneven under vanity adjust **(4)** all four feet to ensure vanity is level.

#### **Ⓒ FIT OFF & ADJUST**

Position **(5)** internal draw box, using locating dowel. Replace any shelves, doors and adjust to ensure all are square with the installed vanity.

#### **Door Adjustment**

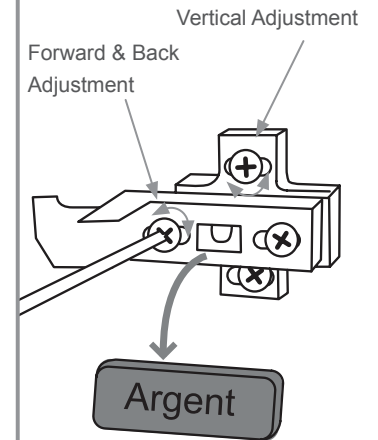

#### **Feet Adjustment**

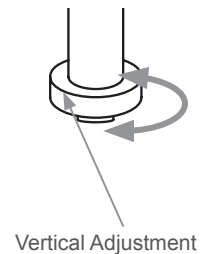

#### **IMPORTANT:**

**INSPECT THE FURNITURE TO ENSURE NO DAMAGE HAS OCCURRED DURING TRANSIT. IF DAMAGE HAS OCCURRED, OR VISIBLE DEFECTS EXIST, DO NOT PROCEED WITH INSTALLATION AND ADVISE ARGENT IMMEDIATELY.**