

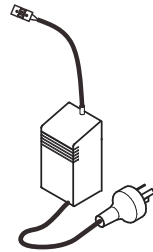

INSTALLATION INSTRUCTIONS

ET3-R URINAL FLUSH VALVE

5 Star WELS Rated

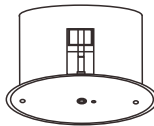
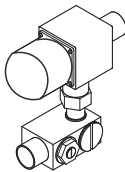

Thank you for purchasing this Enviro-Tech product



INSTALLATION INSTRUCTIONS ET3-R URINAL FLUSH VALVE

We strongly recommend that you use a qualified and registered plumber and electrician.

Note:

Always flush pipe work before installation.

Any deviation from this instruction will void any warranty.

Ceiling must be level, if ceiling is sloping/pitched the detection zone will be altered.

SOLENOID VALVE INSTALLATION

- > Attach bracket then fix solenoid valve into it.
- > Connect water feed to inlet of valve.
- > Connect outlet to urinal.

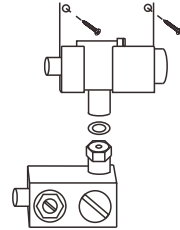

SENSOR INSTALLATION

Single Urinal

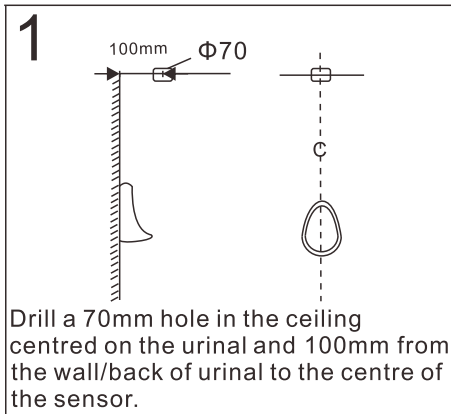

Drill a 70mm hole in the ceiling centred on the urinal and 100mm from the wall/back of urinal to the centre of the sensor.

Twin or Trough Urinals

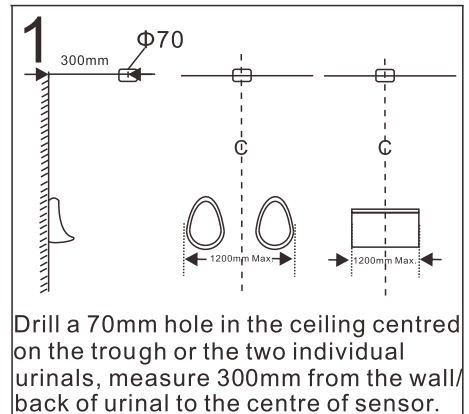

Drill a 70mm hole in the ceiling centred on the trough or the two individual urinals, measure 300mm from the wall/back of urinal to the centre of sensor.

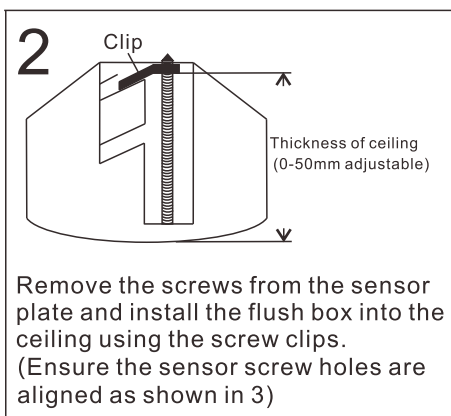

Remove the screws from the sensor plate and install the flush box into the ceiling using the screw clips. (Ensure the sensor screw holes are aligned as shown in 3)

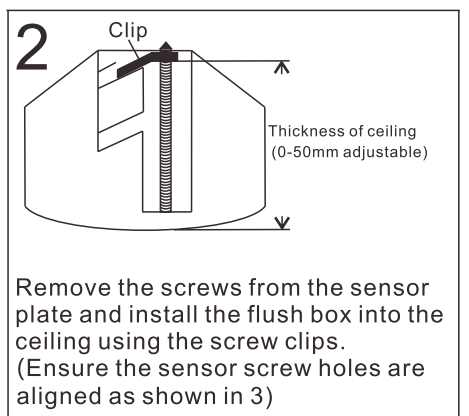

Remove the screws from the sensor plate and install the flush box into the ceiling using the screw clips. (Ensure the sensor screw holes are aligned as shown in 3)

Single Urinal

3

Ceiling
Wall

Single urinal: Refix the sensor plate using the 2 screws, ensure sensor plate screws are parallel to wall for the single urinal. (Before refixing make any changes if required to flush time or preflush settings, refer to page 4 and 5)

Twin or Trough Urinals

3

Ceiling 90°
Wall

Twin or Trough urinals: Refix the sensor plate using the 2 screws, ensure sensor plate screws are aligned facing the wall. (Before refixing make any changes if required to flush time or preflush settings, refer to page 4 and 5)

4

Connect solenoid valve to sensor(black plugs), and connect sensor to transformer(white plugs). Connect to power only when installation is complete, system will then run test and be ready for use.

4

Connect solenoid valve to sensor(black plugs), and connect sensor to transformer(white plugs). Connect to power only when installation is complete, system will then run test and be ready for use.

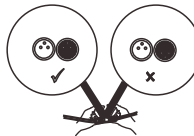
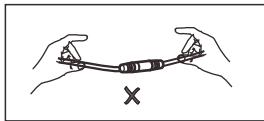
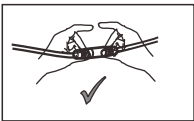

Attention:

Hold the plug not the wire to connect and dis-connect and make sure the pins align to the holes in the right position.

COMPONENTS

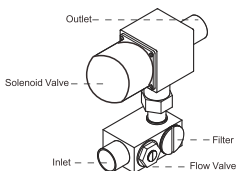

1. Solenoid Valve



2. Sensor

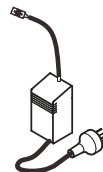

3. Transformer

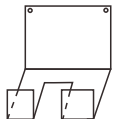

4. Bracket

SETTINGS

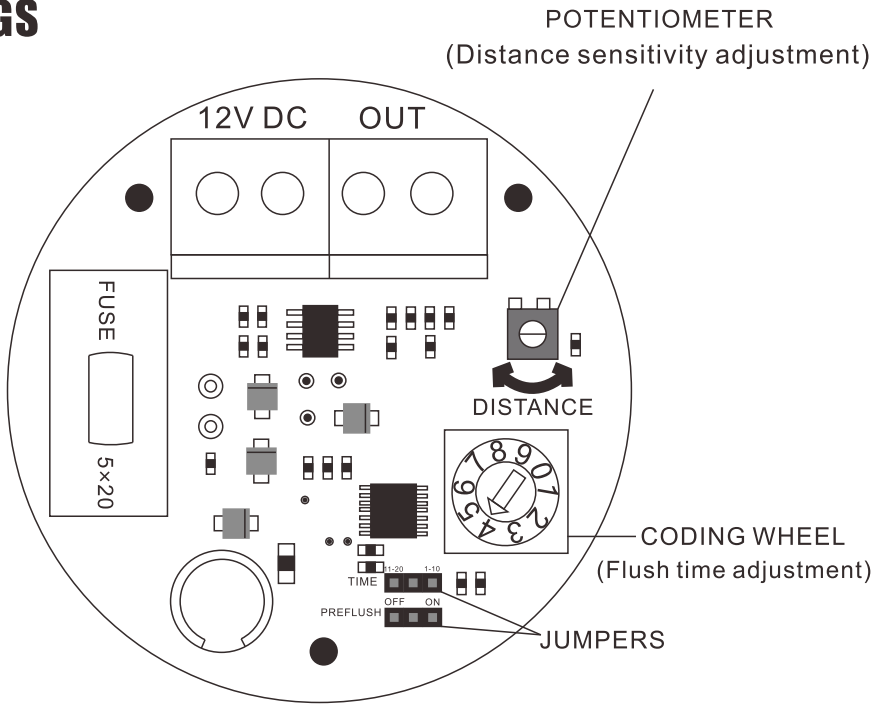

Distance

Turn the potentiometer clockwise to increase the sensing distance and anti-clockwise to decrease it.

Preflush

Preflush on/off

Set the jumper to left(OFF) to turn off the preflush and set the jumper to right(ON) to turn on the preflush.

The factory setting is left(ON).

Full Flush

Set the jumper to left to choose 11-20s(20s=0s) and right to choose 1-10s(10s=0s) adjusting range.

Set the Coding wheel to required flush time.

(Factory setting is preflush "ON" time "4"(1-10 jumper right) at 350Kpa will give a flush volume of 0.8ltr for a single urinal)

FLUSH VOLUME SETTINGS

Time settings for flush volumes without "Preflush"			
Urinal Type	Dynamic Pressure	Time Setting	Flush Volume
Single Urinal	350kPa	6s	0.8L
	500kPa	5s	
Twin Urinal	350kPa	12s	1.6L
	450kPa	11s	
	550kPa	10s(10=0)	
Slab/Trough Urinal	350kPa	19s	2.4L
	400kPa	17s	
	450kPa	16s	
	500kPa	15s	

Time settings for flush volumes with "Preflush"			
Urinal Type	Dynamic Pressure	Time Setting	Flush Volume
Single Urinal	350kPa	4s	0.8L
	500kPa	3s	
Twin Urinal	350kPa	8s	1.6L
	450kPa	7s	
	550kPa	6s	
Slab/Trough Urinal	350kPa	12s	2.4L
	400kPa	11s	
	500kPa	10s(10=0)	

DETECTION ZONE (Guide only)

2.4 M Height Installation

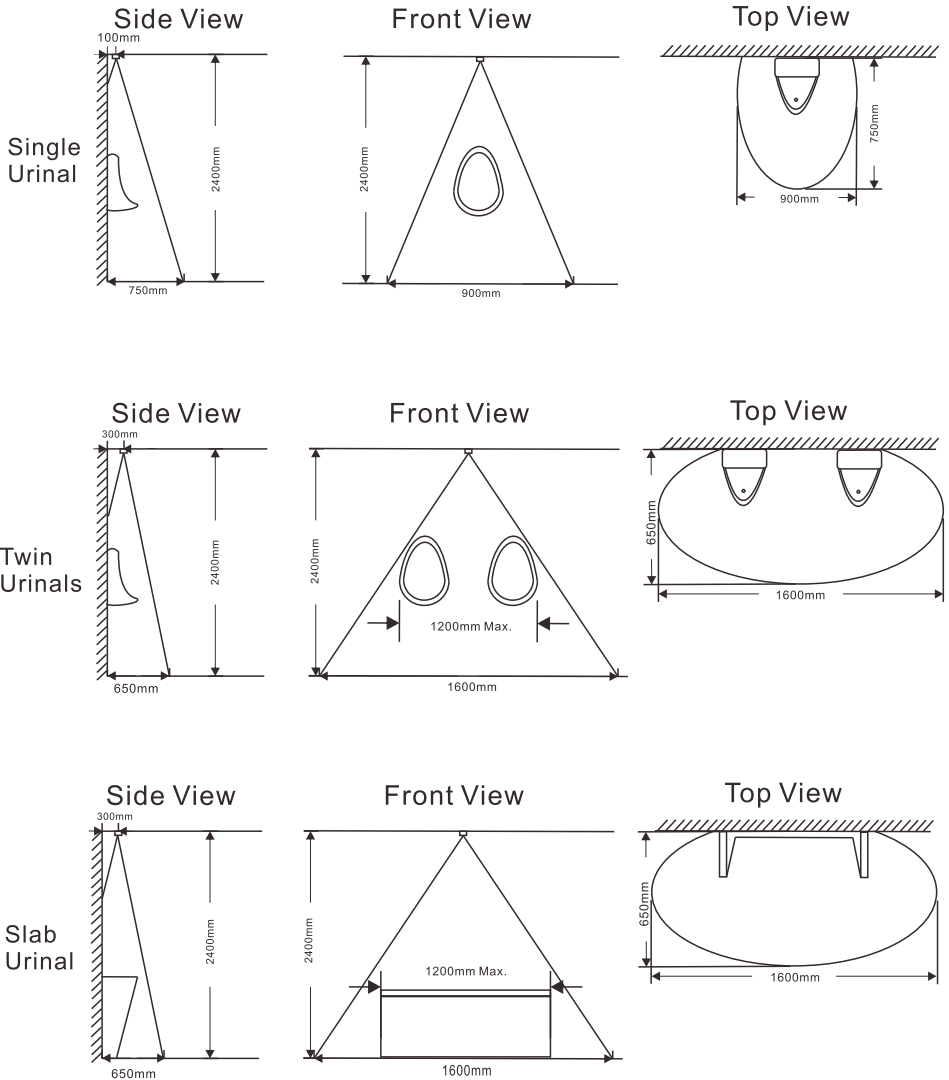

DETECTION ZONE (Guide only)

3 M Height Installation

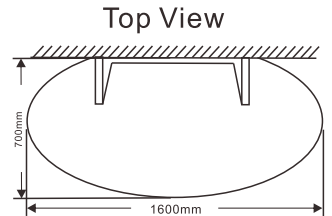
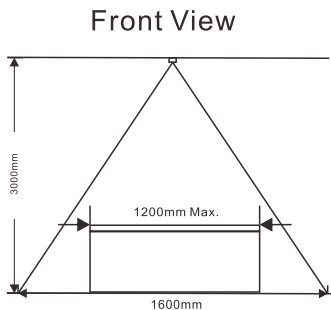
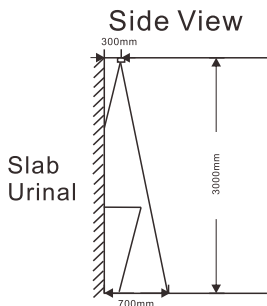
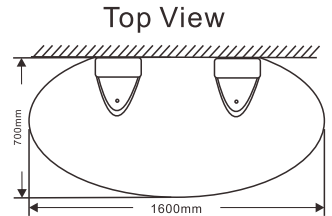
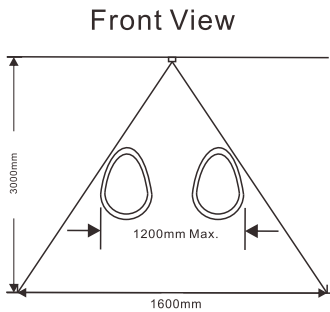
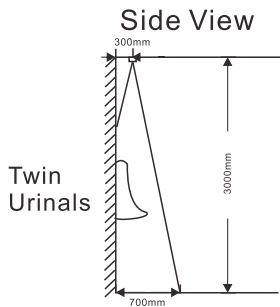
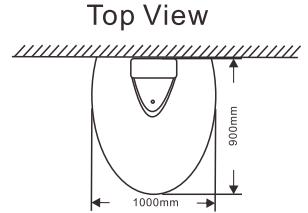
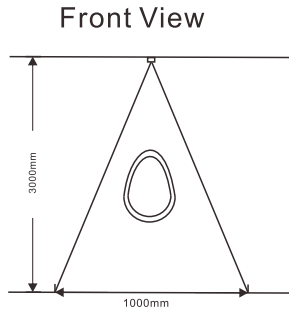
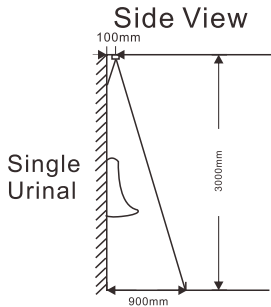

TECHNICAL SPECIFICATION

Function	ET3-R
Power Input	AC220 -240V (50/60 Hz)
Power consumption	900mA
Water Pressure	100kPa-500kPa (recommended 350kPa)
Inlet/outlet Diameter	15mm ½ G
Detection zone	1600×1000mm(adjustable)
Inductive confirmation times	6 times within 5 seconds
Confirmation time after use	5 seconds
Flush time	4 Seconds (adjustable)
Reset time after flush	20 Seconds
Trap seal protection	Automatic flush every 6hrs if not used
Flush delay time	After user leaves: 30 Secs

TROUBLE SHOOTING

Problem	Possible Cause	Solution
No water	Plugs incorrectly joined or unplugged. No power Water supply cut off low Water pressure Blocked filter	Take plugs apart and replug after 2 minutes Check power supply Check water supply Increase water pressure Clean filter
Low flush volume	Low Water pressure Low flush volume Blocked filter	Increase water pressure Adjust flow valve Clean filter
High flush volume	High flush volume High water pressure	Adjust flow valve Decrease water pressure

Please contact manufacturer if required

Australia: 1300 530 883

New Zealand: 0800 2 ENVIRO

This automatic urinal flush valve is manufactured strictly to adhere to the ISO9001 standard, WaterMark certification and WELS standards. Enviro-tech has the right of updating the product technology.